

A photograph of a herd of wild horses in a desert landscape. The horses are scattered across a valley floor covered with sparse, dry vegetation and rocks. In the background, there are large, rugged, brown mountains under a clear blue sky. The image is partially obscured by a dark grey curved overlay on the right side.

Virginia Range Horses Community Informational Meeting

10/10/22

City of Reno
Nevada Department of Transportation
Wild Horse Connection
American Wild Horse Campaign

Meeting Purpose

Discussing community informed solutions to reduce accidents between vehicles and horses.

Presenting solutions and work completed to-date.

Previous Workshops

Community Information Session I:

February 10, 2022*

Community Information Session II:

May 16, 2022*

Community Information Session III:

October 10, 2022

**Meeting recordings, presentations, and FAQs can be found at
reno.gov/horses*

Meeting Overview

Facilitator Role

Direct the panel questions. Moderate Q&A between all sources

Participants' Role

Concisely ask questions. Provide your perspective. Share your proposed solutions.

Meeting is being recorded. All chat, live comments, video.

Meeting Flow

5 mins

Welcome

Councilmember Duerr

Introductions & Rules of Engagement

Facilitator: Erica Olsen, OnStrategy

Horse Education

Tracy Wilson, American Wild Horse Campaign

~30
mins

Fencing – Proposed Solutions (Cattle Guards & NDOT Updates)

Brooklyn Oswald & John Flansberg, City of Reno, Tara Smaltz, NDOT

Feeding – Proposed Solutions (Signage & Diversionary Feeding)

Corenna Vance, Wild Horse Connection & Tracy Wilson, American Wild Horse Campaign

Speeding– Proposed Solutions (Speeding & Signage)

John Flansberg, Kurt Dietrich, & Travis Truhill, City of Reno

~60
mins

Live Public Discussion & Q&A

Panelists

Naomi Duerr

Councilmember, City of Reno

Jackie Bryant

Assistant City Manager, City of Reno

John Flansberg, P.E.

Regional Infrastructure Administrator, City of Reno

Tracy Wilson

NV State Director, American Wild Horse Campaign

Sean Garlock, Commander

Community Services Division, City of Reno

Travis Truhill

Director of Maintenance & Ops, City of Reno

Kurt Dietrich, P.E.

Traffic Engineer, City of Reno

Brooklyn Oswald, PLA

Associate Planner Development Services, City of Reno

Tara Smaltz, P.E.

Principal Scoping Engineer, NDOT

Corenna Vance

President, Wild Horse Connection

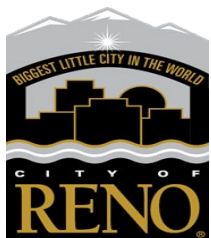

How to Participate In Live Q&A

Zoom

1. Click Raise Hand in the webinar controls
2. Hit Unmute when prompted

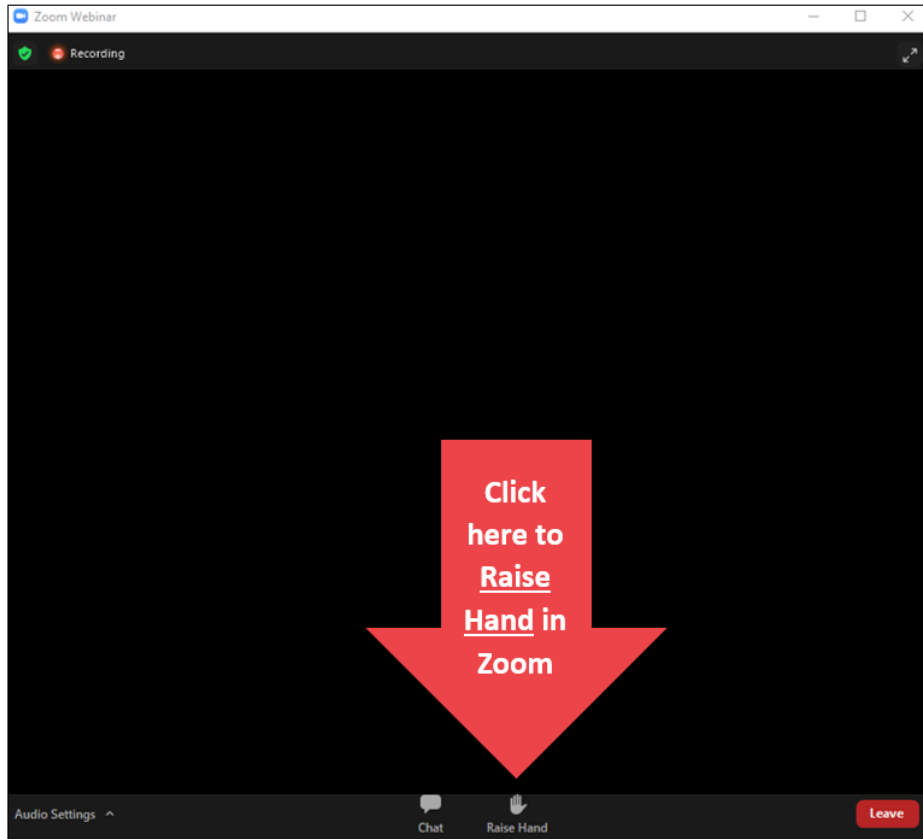

Phone

1. Dial *9
2. Dial *6 to unmute when prompted

Please try to limit **comments to 3-4 minutes.**

When you are brought in, **you will remain in the system so you can ask follow up questions.** Please allow all speakers to finish.

You are able to **share your screen.**

How to Participate In Zoom Q&A

Q&A: Zoom

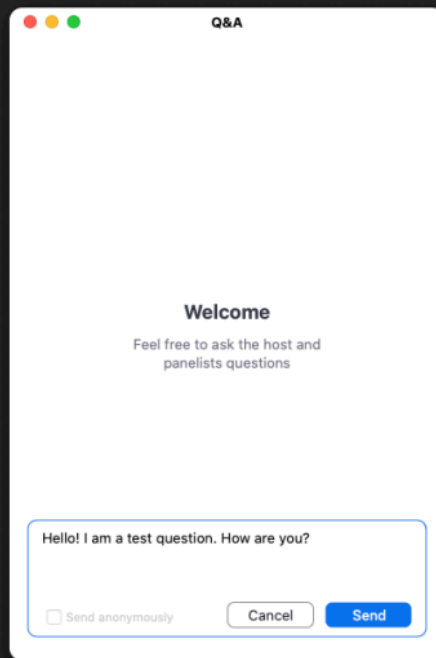

The screenshot shows a white Q&A window with a title bar containing three colored dots (red, yellow, green) and the text "Q&A". The main content area has the heading "Welcome" and the text "Feel free to ask the host and panelists questions". Below this is a text input field containing the text "Hello! I am a test question. How are you?". At the bottom of the window, there is a checkbox labeled "Send anonymously" which is currently unchecked, and two buttons: "Cancel" and "Send".

Click the **Q&A icon** to submit a question.

Type your question and hit **“send”**.

You can view all participant-submit questions in the Q&A window. To “up-vote” a question, **click the thumbs up icon below the question you wish to “up-voting”**.

Rules of Engagement

Be concise to allow us to hear from as many people as possible.

Be considerate and respectful. We appreciate your input about the issues and not about individuals.

Listen and be heard. We are here to hear all perspectives and reduce misunderstandings.

Unanswered Questions

Parking Lot

Questions that can't be answered today.

Additional Questions in Queue

Questions in chat that we could not get to today.



Horses of the Virginia Range





Structure

Are they
a herd?

Are they
a band?



Deb Sutherland 2022



A **BAND** is what we consider a family unit.

Several bands together in an area make up a **HERD**.





Family Band

A Band Stallion is the protector, warding off challenges by other stallions and threats. He also has breeding rights to the mares in the band.



Del Sutherland 2022



Lead Mare

The lead mare often makes the decisions when it's time for the band to go to water, or to rest, or to move on. She can often be seen on alert and warning the rest of the band of perceived danger.



Bands can consist of just two horses or many more...

Mares

After the lead mare there can be other mares in the band. They often form close relationships and stick tightly together.

Colts and Fillies

Colts are male offspring who generally get pushed out of the band at 2-3 years old. They spend several years with other "bachelor" stallions until they are mature enough to form their own band. Fillies are often allowed to be stolen by other stallions, moving on to join a new family band.

Lieutenant Stallion

Some bands have a lieutenant who takes care of the protection of the band and sometimes has breeding rights.



The lead mare is out front, young horse in the middle of other mares and the band stallion bringing up the rear - a common sight on the Virginia Range!



Did You Know?

**Some fun facts about
Virginia Range Horses**



Flehmen Response

Are they making funny faces? Horses and other animals have an auxiliary scent organ above the roof of the mouth. By curling the upper lip above the teeth and gums they enhance the scent through a duct behind the front teeth and can explore a scent of interest!

Ellen Albiter



Sparring

While stallions can certainly be seen fighting for protection of a band, you may also see what looks like fighting but is actually bachelor stallions "sparring" or "practicing" their skills. While it can seem intense, they will often just stop and walk away together to graze.





Physical Connection

Horses can often be seen in physical contact with each other, especially at rest. This can be to help ward off flies in summer, share body heat in winter, but they also do it to express their deep connection to each other.





Photos by:
Deb Sutherland
Ellen Albiter
American Wild Horse Campaign

Thank you!

Enjoy safely viewing the
Virginia Range Horses from a
distance of at least 100 feet.

Fencing

John Flansberg, City of Reno

Brooklyn Oswald, City of Reno

Tara Smaltz, NDOT

Community Concerns & Working Solutions

Virginia Range Land Ownership

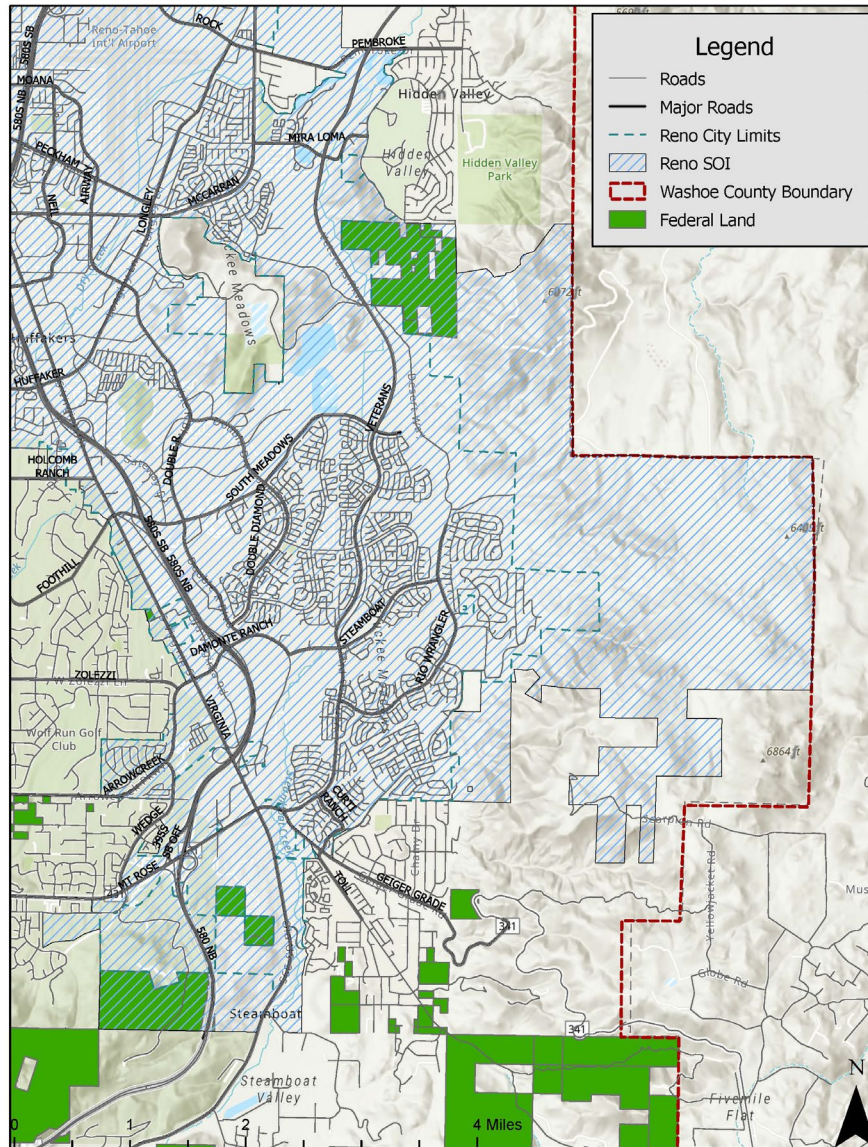

Private Ownership

- City and County Boundaries
- Sphere of Influence

Public Land Portions

- Steamboat and Veterans Parkway area
- Proximity to Virginia City
- Not Herd Management Areas

Horses Fence Exhibit Map

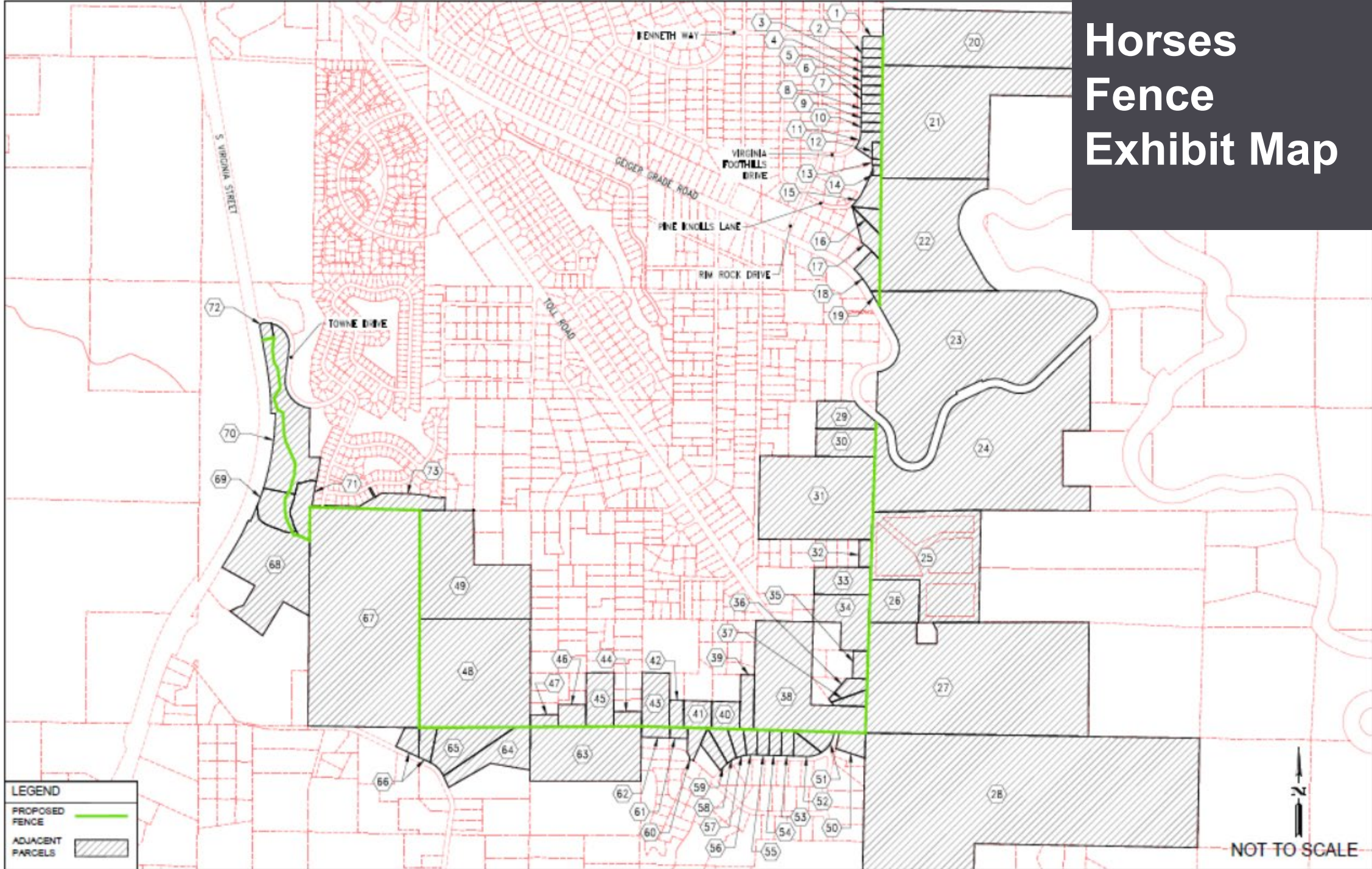

Planned Fencing Projects

Recent Completed

- Canyons Edge fencing proposal and verbal commitments
- DPII fencing and gate standards and requirements

Under Consideration

- Considering options for wildlife crossing at Geiger Grade
- Joint fencing program in South Reno

Talus Valley & Rio Wrangler Updates



Updated Development Fence Standards

POTENTIAL GATE DESIGNS

DETAIL A
PEDESTRIAN PASS-THROUGH GATE
(KISSING GATE)

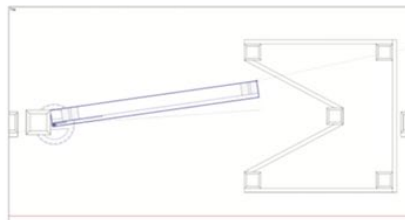
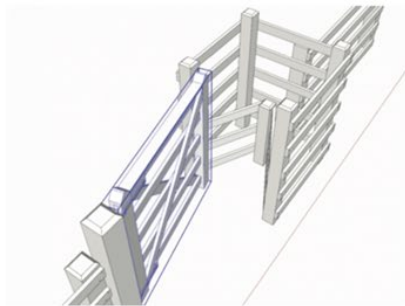
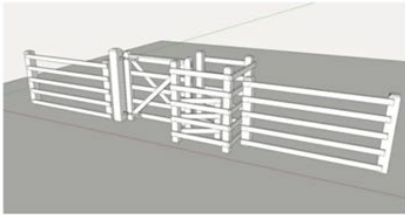

DETAIL B
VEHICLE GATE WITH CATTLE GUARD

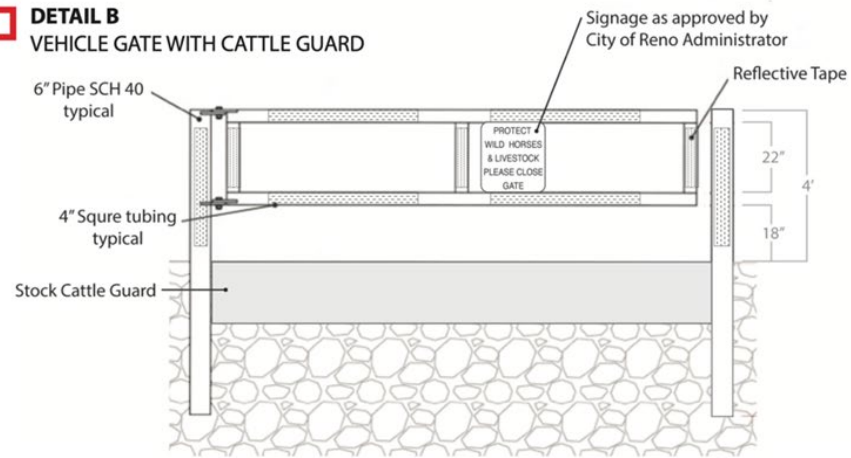

DETAIL C
LOCKED EMERGENCY HORSE GATE



Feeding

*Corenna Vance, Wild Horse Connection &
Tracy Wilson, American Wild Horses Campaign
Community Concerns & Working Solutions*

Illegal Feeding & Diversionary Feeding

Completed & In-Progress

- Diversionary feeding purpose
- Approved diversionary feeding is starting for the season
- New 2022 sites will be an approved half mile distance from roads/buildings/structures or approved on a case-by-case basis
- Signage related to illegal feeding by WHC and City of Reno

Under Consideration

- Public service campaign

Illegal Feeding Signage

DO NOT FEED



Virginia Range Wild Horses

- They can only digest range forage.
- Your "harmless" snack can KILL.
- Apples, carrots, fruit, or ANY food can cause choking and/or colic often resulting in painful death.
- Stay 100 feet from wild horses.

**For injured or at risk horses
or to report other issues:**

**Wild Horse Hotline
775-352-3944**

wildhorseconnection.org
Range Management



DO NOT FEED



Wild Horse Laws:

Illegal to Feed or Harass Wild Horses.

NRS 569.040, NRS 504.490

UP TO \$2,000 FINE

Preliminary analysis of the Jan-June time period comparing 2020 to 2022 shows:



61.4%
Reduction
in births

Mortality Rate (mostly predation) of foals born traditionally holds around 50% by 15 months of age

Population rate along the City of Reno interface, from Hidden Valley to Geiger Grade has started to DECREASE with more deaths than births.

Speeding

Travis Truhill, City of Reno

Kurt Dietrich, City of Reno

John Flansberg, City of Reno

Community Concerns & Working Solutions

Speed Radar & Horse Crossing Signs

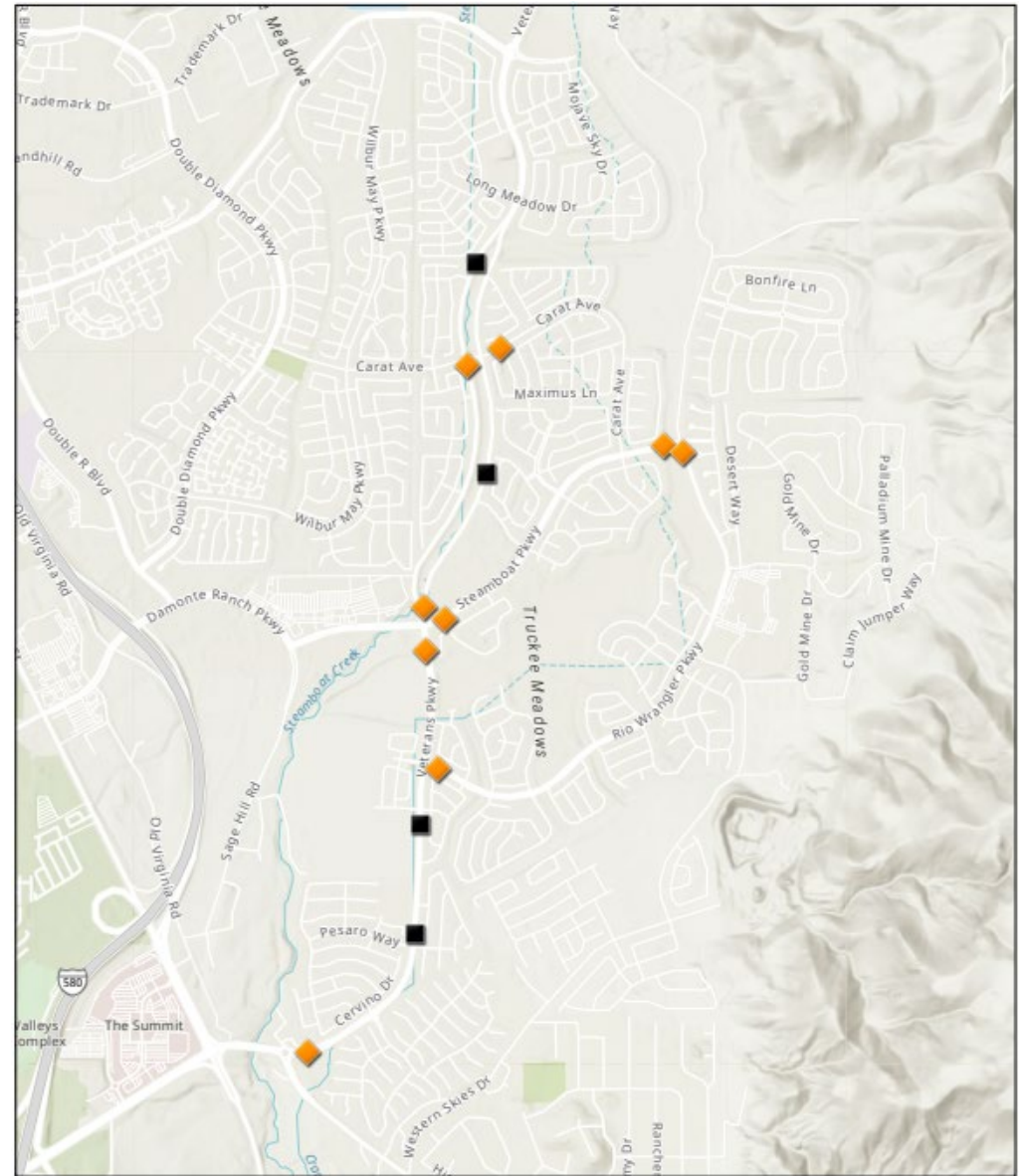

■ Radar Speed Sign

◆ Horse Crossing Sign

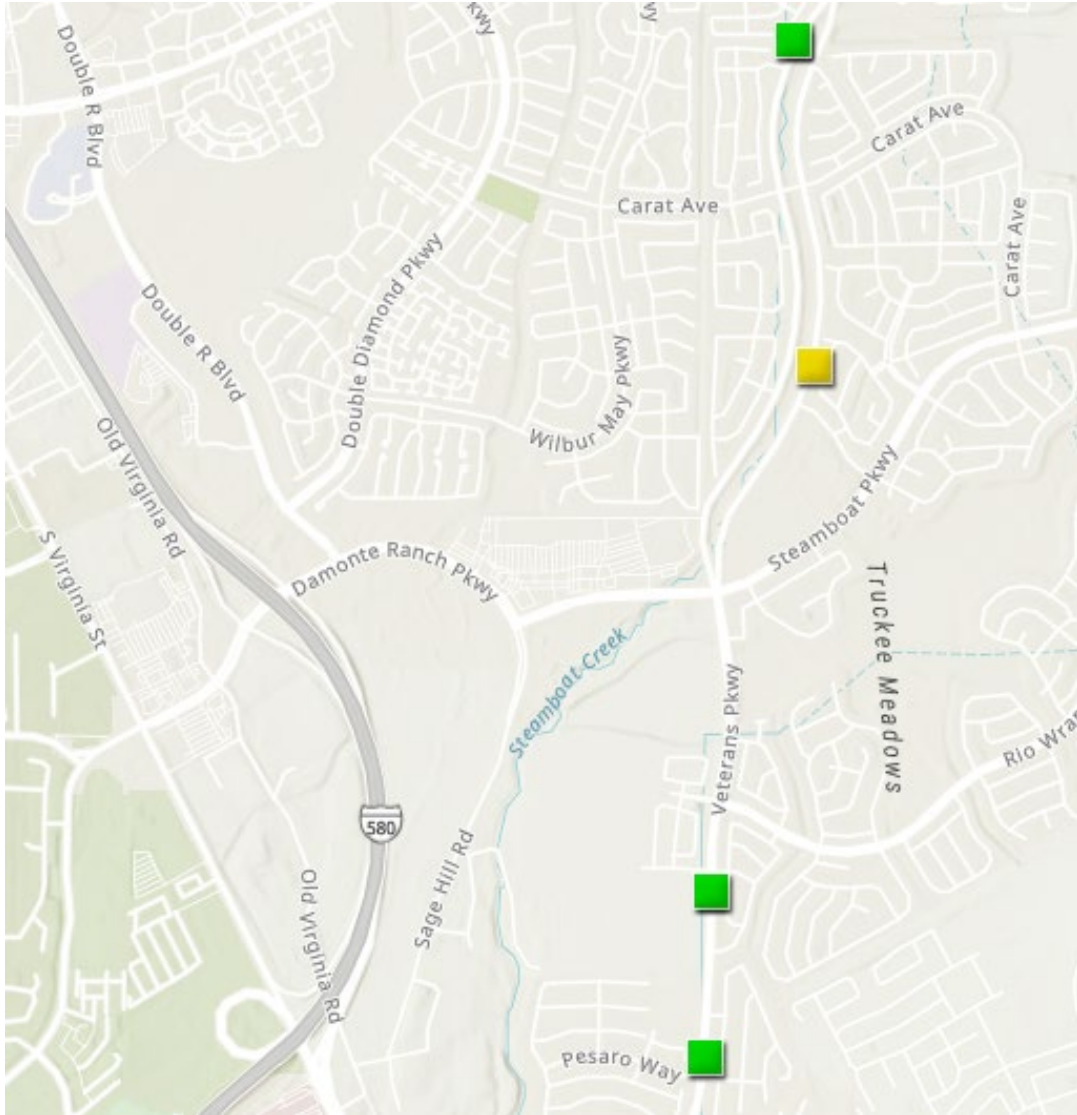

85th-Percentile Speeds for the Veterans Pkwy Speed Radar Signs

(Posted Speed Limit: 45 MPH)

	South Bound	North Bound
North	48	51
South	47	44

Actions Taken To Improve Safety

Completed & In-Progress

- South Veteran's Parkway Speed Study
- Installation of speed radar feedback signs (4 total)
- Rio Wrangler Parkway & Steamboat Parkway lowered speed limits
- Social media campaigns and public outreach campaigns on dangers of speeding

Under Consideration

- Research into creating an advisory speed limit at night vs regulatory speed during day on Veterans Parkway.

Panelists

Naomi Duerr

Councilmember, City of Reno

Jackie Bryant

Assistant City Manager, City of Reno

John Flansberg, P.E.

Regional Infrastructure Administrator, City of Reno

Tracy Wilson

NV State Director, American Wild Horse Campaign

Sean Garlock, Commander

Community Services Division, City of Reno

Travis Truhill

Director of Maintenance & Ops, City of Reno

Kurt Dietrich, P.E.

Traffic Engineer, City of Reno

Brooklyn Oswald, PLA

Associate Planner Development Services, City of Reno

Tara Smaltz, P.E.

Principal Scoping Engineer, NDOT

Corenna Vance

President, Wild Horse Connection





Wrap & Next Steps

Thank you for your time and participation!
Feedback form at link below.

Wild Horse Hotline: 775-352-3944

Up-to-Date Info: [Reno.gov/horses](https://reno.gov/horses)

APPENDIX

Veterans Parkway Speed Study

- Staff performed a Federal Highway Administration USLIMITS2 speed study on Veterans Parkway.
- Roadway geometrics, land use, pedestrian & bicycle activity, free flow vehicle speeds, crashes, amongst other factors are considered.
- The 85th-Percentile Speed was measured at 50 MPH. The 50th-Percentile Speed was measured at 43 MPH.
- 45 MPH (50th-Percentile) posted speed limit was selected due to pedestrian and bicycle activity.

Veterans Parkway Speed Study



Speed Radar Locations

