

**NOTES:**

1. GREASE PORTION OF BARS EXTENDING ACROSS JOINT AND PROVIDE CAP OR SLEEVE ON END TO PERMIT MOVEMENT.
2. COVER EARTH SIDE OF JOINT WITH A STRIP OF MEMBRANE WATERPROOFING TO PREVENT SEEPAGE THROUGH JOINT.
3. PROVIDE 12" THICK 3/4" DRAIN ROCK BEHIND WALL.
4. SEE MASONRY RETAINING WALL DETAILS R-504B AND MASONRY RETAINING WALL NOTES, R-504C AND R-504D

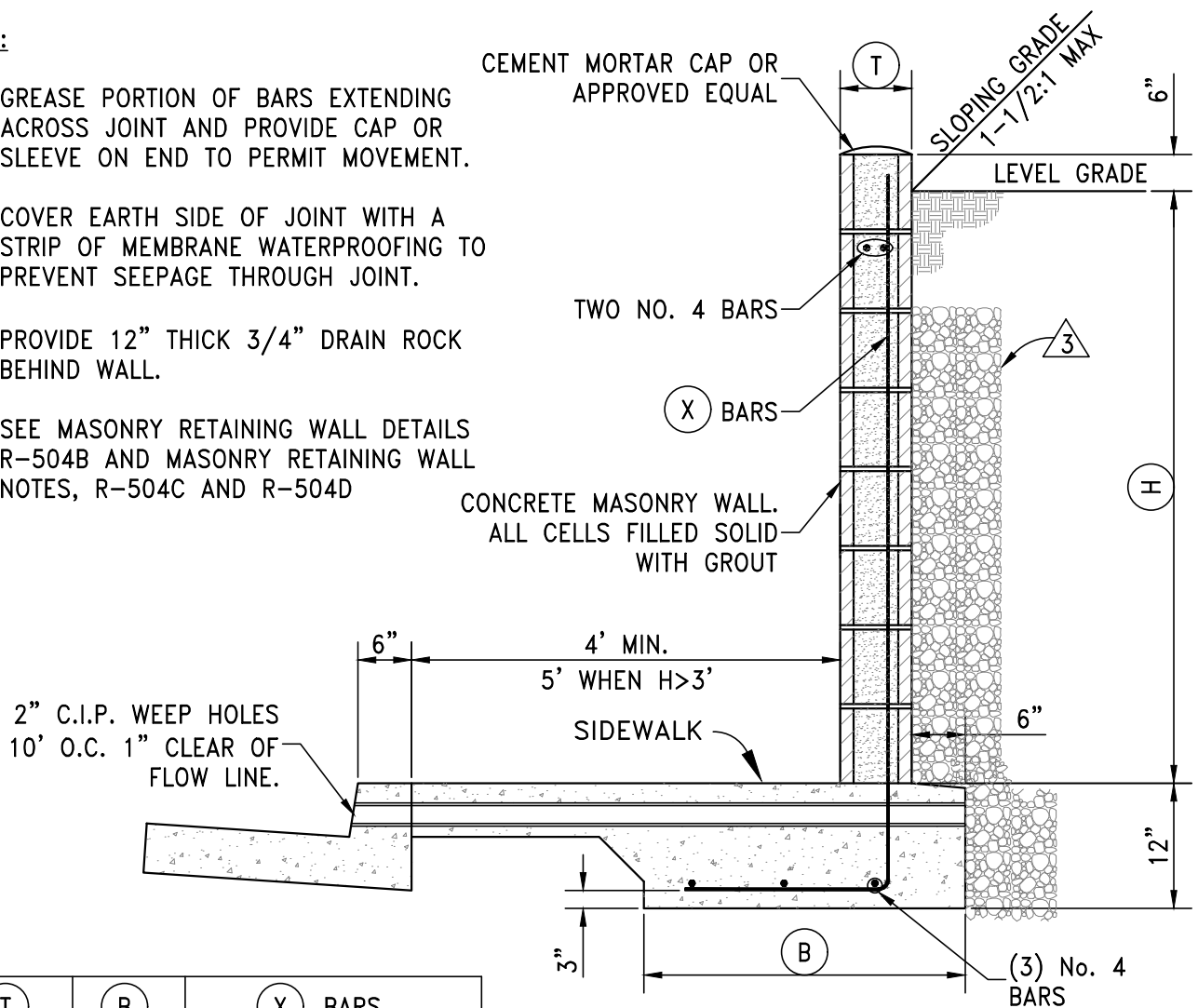

**TYPICAL SECTION 5' MAX**

(H)	(T)	(B)	(X) BARS
1	7 5/8"	1'-8"	No. 4 AT 24" O.C.
2	7 5/8"	1'-8"	No. 4 AT 24" O.C.
3	7 5/8"	2'-3"	No. 4 AT 24" O.C.
4	7 5/8"	3'-0"	No. 4 AT 24" O.C.
5	7 5/8"	3'-6"	No. 5 AT 16" O.C.

**SLOPING GRADE**

(H)	(T)	(B)	(X) BARS
1	7 5/8"	1'-2"	No. 4 AT 32" O.C.
2	7 5/8"	1'-2"	No. 4 AT 32" O.C.
3	7 5/8"	1'-9"	No. 4 AT 32" O.C.
4	7 5/8"	2'-2"	No. 4 AT 32" O.C.
5	7 5/8"	2'-9"	No. 4 AT 24" O.C.

**LEVEL GRADE**

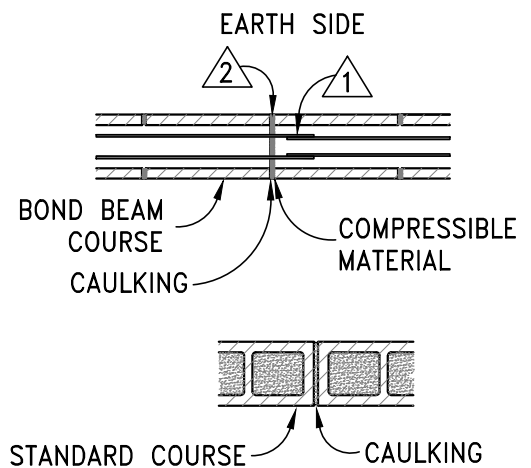

**TYPICAL EXPANSION JOINT DETAIL**



STANDARD DETAILS FOR PUBLIC WORKS CONSTRUCTION

**MASONRY RETAINING WALLS I-L & S**

DRAWING No.

**R-604A**

APPROVED BY: JF DATE: 12/2019