

# Existing Elevator Guideline

*Elevator - Decommission*

EXISTING ELEVATOR

## STEPS TO PLACE AN EXISTING ELEVATOR TO STATUS OF "IN-ACTIVE" W/ THE STATE.

1. BUILDING OWNER SHALL BE RESPONSIBLE FOR CONTACTING THE STATE OF NEVADA - MECHANICAL COMPLIANCE SECTION OF THE DIVISION OF INDUSTRIAL RELATIONS AT PHONE NUMBER 702-486-9054 OR ONLINE AT [dir.nv.gov/MCS/HOME/](http://dir.nv.gov/MCS/HOME/)
2. BUILDING OWNER SHALL SET UP AN ON-SITE APPOINTMENT WITH THE STATE FOR AN INSPECTION AND DISCONNECT OF THE ELEVATOR.
3. BUILDING OWNER SHALL BE RESPONSIBLE TO COORDINATE WITH THE CITY OF RENO BUILDING & SAFETY DIVISION IN SEALING UP THE OPENING OF THE IN-ACTIVE ELEVATOR. SEE DETAIL BELOW.
4. SUBMIT CITY APPLICATION AND PLANS FOR WALL CONSTRUCTION. A PLAN REVIEW WILL BE CONDUCTED AND A BUILDING PERMIT ISSUED UPON APPROVAL.

**NOTE:**  
EXISTING ELEVATOR MUST BE IN A BUILDING THAT IS 3 STORIES OR LESS

REMOVE ALL CALL BUTTONS, SIGNAGE AND ELEVATOR ITEMS

5/8" TYPE "X" GYPSUM BOARD O/  
3 5/8" METAL STUDS AT 16" O.C.  
TAPE SMOOTH TEXTURE W/  
PAINT FINISH

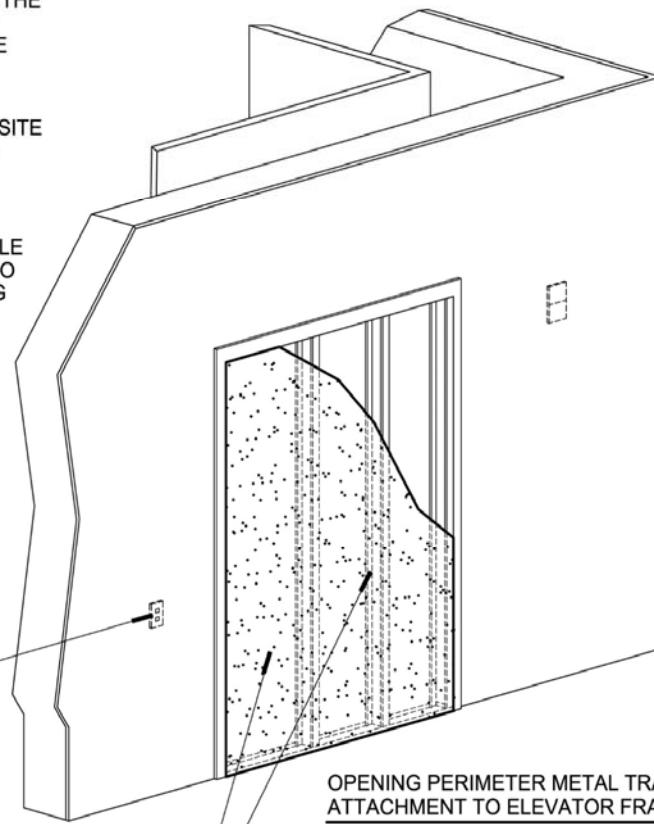

### OPENING PERIMETER METAL TRACK ATTACHMENT TO ELEVATOR FRAME

- A. FASTEN SIDE AND TOP TRACKS W/ SHEET METAL SCREWS.
- B. FASTEN BOTTOM TRACK WITH .145 P.A.F. WITH 1" EMBEDMENT AT 10" O.C. STAGGERED TRACK AT CONCRETE FLOOR.  
OR  
FASTEN BOTTOM TRACK WITH WOOD SCREWS AT 8" O.C. STAGGERED TRACK TO NEW 2x BLOCKING AT WOOD FLOORING.
- C. ALT. METHODS MAY BE APPROVED ON A CASE BY CASE BASIS.

## ELEVATOR OPENING WALL FRAMING DETAIL