

NOTE: INFRASTRUCTURE LOCATIONS AND SIZES ARE CONCEPTUAL AND WILL BE REFINED WHEN MORE DETAILED FACILITY PLANS ARE DEVELOPED.

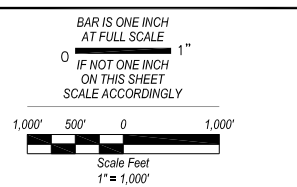
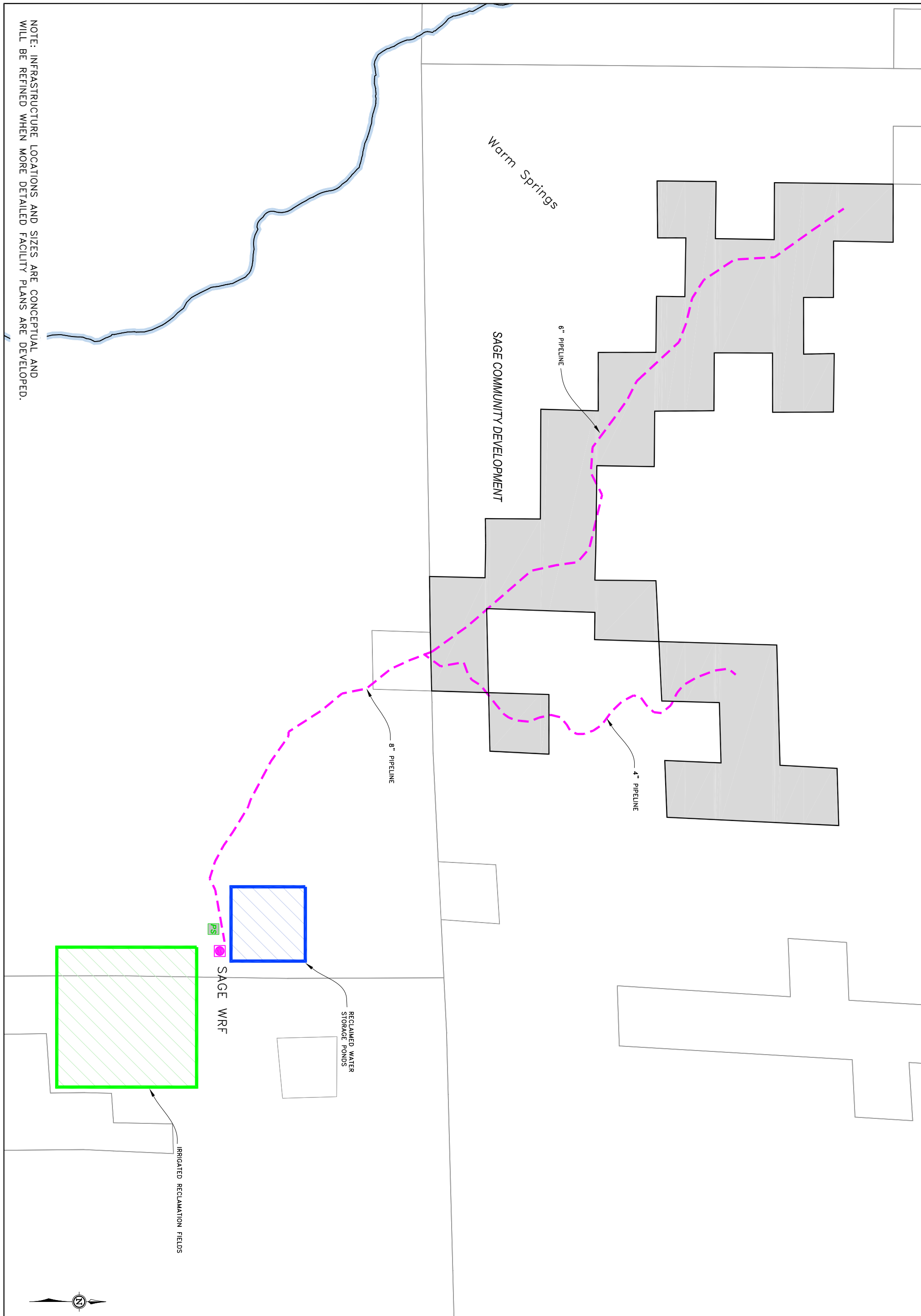

MAP SYMBOLS			
	WATER RECLAMATION FACILITY		RECLAIMED WATER PIPELINE (PROPOSED)
	PUMP STATION		CITY OF RENO TMSA
	HYDROBASIN BOUNDARY		OUTSIDE TMSA

Consulting Engineers  
 10381 Double R, Boulevard Reno, Nevada 89521  
 Phone: (775) 827-2311 Fax: (775) 827-2316

SAGE TMSA - FIGURE 3-5					
PLANNED RECLAIMED WATER FACILITIES					
COUNTY OF WASHOE, NEVADA					
REV NO.	REVISION	BY	JOB #	DESIGNED	DRAWN
			RENO06-002	JPE/CVB	JBW
			DATE	JUNE 2007	CVB
			SCALE	1" = 1,000'	